



# Wheel Loader Links, Bellcranks, Pins & Bushings

# SECTION E

## WHEEL LOADER LINK, BELLCRANKS, PINS, & BUSHINGS

---

	<b>Page</b>
<b>CASE</b>	E1
<b>CAT</b>	E5
<b>JOHN DEERE</b>	E2-E4

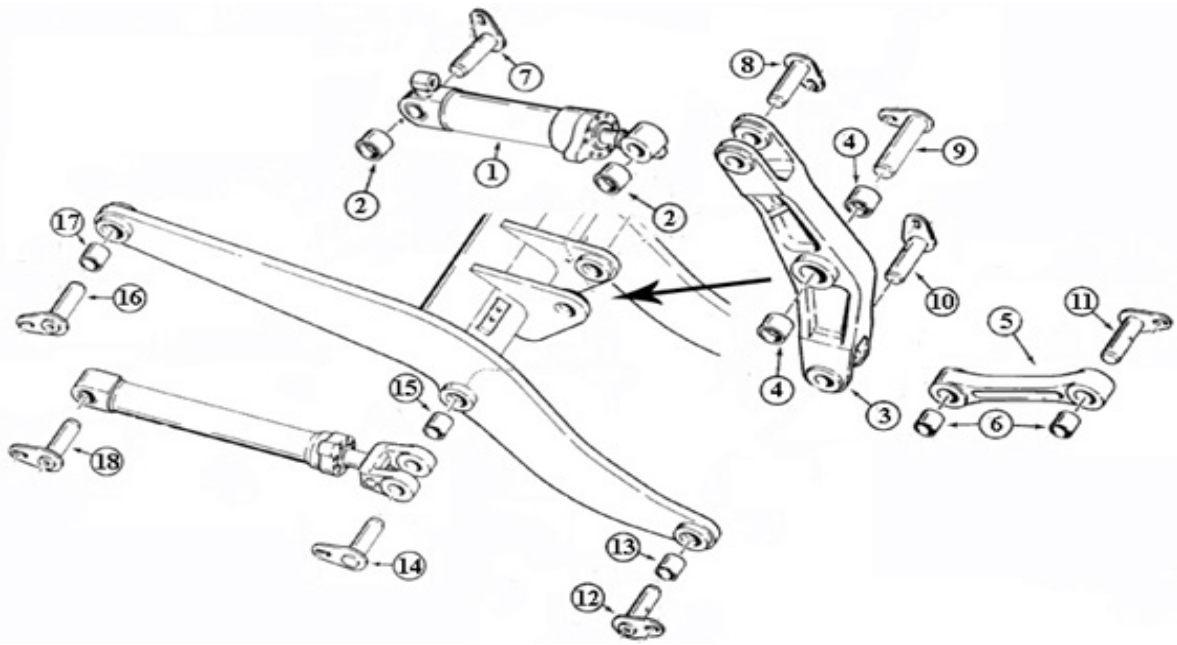

Ref.	Part No.	Description	Notes	Qty.	Wt.
<b>CASE 621, 621B, (621C W/ Z-BAR LOADER)</b>					
1	339921A1	Tilt Cylinder	Loader Bucket	1	312
2	L127014	Bushing		2	2.4
	1543306C1	Seal Kit		1	0.1
<b>CASE 821, 821B, 821C</b>					
	229402A1	Steering Cylinder		2	71
<b>CASE 621, 621B, 621C, 721, 721B, 721C</b>					
3	232194A1	Bellcrank	With center bushings L118709	1	577
5	L118759	Link	Bellcrank to Bucket	1	124
6	L127015	Bushing		2	2.2
7/8	L118674	Pin	Tilt Cylinder Both Ends	2	25
9	L118672	Pin	Center Bellcrank	1	45
10/11/12	225775A1	Pin	Bellcrank to Link & Bucket Pins	4	22
13/15	L127015	Bushing	Loader Lift Frame	4	2.2
16	L118674	Pin	Loader Lift Frame To Machine	2	25
17	L127014	Bushing	Loader Lift Frame To Machine	2	2.4
18	225775A1	Pin	Lift Cylinder Tube End	2	22
<b>CASE 821, 821B, 821C</b>					
3	L130049	Bellcrank	With center bushings L125971	1	646
5	L128196	Link	Bellcrank to Bucket	1	128
6	L125957	Bushing		2	2.2
7	L118674	Pin	Tilt Cylinder to Machine	1	25
8	L125176	Pin	Tilt Cylinder to Bellcrank	1	25
9	L125016	Pin	Center Bellcrank	1	57
10/11/12	225775A1	Pin	Bellcrank to Link & Bucket Pins	4	22
14	L125176	Pin	Lift Cylinder to Loader Lift Frame	2	25
<b>CASE 921, 921B, 921C</b>					
3	L129924	Bellcrank	With center bushings L128185	1	1146
5	L129925	Link	Bellcrank to Bucket	1	151
6	L129906	Bushing		2	3.2

# BELLCRANKS, LINKS, PINS, & BUSHINGS

JOHN DEERE

Ref.	Part No.	Description	Notes	Qty.	Wt.
<b>JOHN DEERE 344E</b>					
3	AT122464	Bellcrank	With center bushings	1	344
4	AT122209	Bushing		2	2
5	AT122465	Link	Bellcrank to Bucket, with bushings	1	80
6	AT122208	Bushing		2	1.7
8	AT122438	Pin	Cylinder to Bellcrank	1	9.25
9	AT122440	Pin	Center Bellcrank	1	19
10	AT122439	Pin	Link to Bellcrank	1	8.1
11	AT121740	Pin	Link to Bucket	1	8.1
12	AT122436	Pin	Bottom Bucket Pins	2	8.1
<b>JOHN DEERE 344G</b>					
3	AT172642	Bellcrank	With center bushings	1	344
4	AT122209	Bushing		2	2
5	AT204679	Link	Bellcrank to Bucket, with bushings	1	80
6	AT203998	Bushing		2	1.7
8	AT204623	Pin	Cylinder to Bellcrank	1	9.25
9	AT204620	Pin	Center Bellcrank	1	19
10	AT204627	Pin	Link to Bellcrank	1	8.1
11	AT204626	Pin	Link to Bucket	1	8.1
12	AT204625	Pin	Bottom Bucket Pins	2	8.1
<b>JOHN DEERE 444E</b>					
3	AT121754	Bellcrank	With center bushings	1	406
4	AT121215	Bushing		2	1.6
5	AT157664	Link	Bellcrank to Bucket, with bushings	1	113
6	AT121218	Bushing		2	1.7
8	AT121738	Pin	Cylinder to Bellcrank	1	9.25
9	AT121741	Pin	Center Bellcrank	1	22
10	AT121740	Pin	Link to Bellcrank	2	8.1
11	AT121739	Pin	Link to Bucket	1	8.1
12	AT121737	Pin	Bottom Bucket Pins	2	8.1
<b>JOHN DEERE 444G</b>					
3	AT172643	Bellcrank	With center bushings	1	406
4	AT121215	Bushing		2	1.6
5	AT204681	Link	Bellcrank to Bucket, with bushings	1	113
6	AT204148	Bushing		2	1.7
8	AT204640	Pin	Cylinder to Bellcrank	1	9.25
9	AT204642	Pin	Center Bellcrank	1	22
10	AT204626	Pin	Link to Bellcrank	2	8.1
11	AT204643	Pin	Link to Bucket	1	8.1
12	AT204625	Pin	Bottom Bucket Pins	2	8.1
<b>JOHN DEERE 444H</b>					
3	AT208546	Bellcrank	With center bushings	1	375
4	T168641	Bushing		2	6.5
5	AT203518	Link	Bellcrank to Bucket, with bushings	1	118
6	T157077	Bushing		2	2.4
8	AT207505	Pin	Cylinder to Bellcrank	1	13
9	AT207507	Pin	Center Bellcrank	1	32
10	AT207504	Pin	Link to Bellcrank	1	12
11	AT207504	Pin	Link to Bucket	1	12
12	AT203599	Pin	Bottom Bucket Pins	2	7.6

**BELLCRANKS, LINKS, PINS, & BUSHINGS****JOHN DEERE**

Ref.	Part No.			Qty.	Wt.
<b>JOHN DEERE 444J</b>					
3	AT307533	Bellcrank	With center bushings	1	375
4	T168641	Bushing		2	6.5
5	AT307532	Link	Bellcrank to Bucket, with bushings	1	118
6	T157077	Bushing		2	2.4
8	AT207505	Pin	Cylinder to Bellcrank	1	13
9	AT207507	Pin	Center Bellcrank	1	32
10	AT207504	Pin	Link to Bellcrank	1	12
11	AT308030	Pin	Link to Bucket	1	12
12	AT308023	Pin	Bottom Bucket Pins	2	7.6

<b>JOHN DEERE 544E, 544G</b>					
3	AT103584	Bellcrank	With center bushings	1	660
5	AT102223	Link	Bellcrank to Bucket, with bushings	1	140
8	AT102228	Pin	Cylinder to Bellcrank	1	17
9	AT102356	Pin	Center Bellcrank	1	39
10	AT102224	Pin	Link to Bellcrank	2	15
11	AT102224	Pin	Link to Bucket	2	15
12	AT115976	Pin	Bottom Bucket Pins	2	10

<b>JOHN DEERE 544H</b>					
5	AT207079	Link	Bellcrank to Bucket, with bushings	1	144
6	T171793	Bushing		2	2.8
8	AT207321	Pin	Cylinder to Bellcrank	1	18
10	AT207321	Pin	Link to Bellcrank	2	18
11	AT207321	Pin	Link to Bucket	1	18
12	AT207051	Pin	Bottom Bucket Pins	2	13

<b>JOHN DEERE 544J</b>					
5	AT307535	Link	Bellcrank to Bucket, with bushings	1	144
6	T171793	Bushing		2	2.8
8	AT207321	Pin	Cylinder to Bellcrank	1	18
10	AT207321	Pin	Link to Bellcrank	2	18
11	AT308031	Pin	Link to Bucket	1	18
12	AT301543	Pin	Bottom Bucket Pins	2	13

<b>JOHN DEERE 624E, 624G</b>					
3	AT103927	Bellcrank	With center bushings	1	630
5	AT103926	Link	Bellcrank to Bucket, with bushing (624E)	1	138
6	T102950	Bushing		2	3.8
5	AT143570	Link	Bellcrank to Bucket, with bushing (624G)	1	138
6	T102950	Bushing		2	3.8
8	AT102827	Pin	Cylinder to Bellcrank	1	24
10	AT102827	Pin	Link to Bellcrank	1	24
11	AT102827	Pin	Link to Bucket	2	24
12	AT103277	Pin	Bottom Bucket Pins	2	15

**BELLCRANKS, LINKS, PINS, & BUSHINGS**

**JOHN DEERE**

Ref.	Part No.	Description	Notes	Qty.	Wt.
<b>JOHN DEERE 624H</b>					
5	AT207688	Link	Bellcrank to Bucket, with bushings	1	162
6	T102950	Bushing		2	3.8
8	AT207718	Pin	Cylinder to Bellcrank	1	25
10	AT210275	Pin	Link to Bellcrank	1	24
11	AT210275	Pin	Link to Bucket	1	24
12	AT207924	Pin	Bottom Bucket Pins	2	15
<b>JOHN DEERE 624J</b>					
5	AT307538	Link	Bellcrank to Bucket, with bushings	1	162
6	T102950	Bushing		2	3.8
8	AT207718	Pin	Cylinder to Bellcrank	1	25
10	AT102827	Pin	Link to Bellcrank (Old # 210275)	2	24
11	AT308025	Pin	Link to Bucket	1	24
12	AT308032	Pin	Bottom Bucket Pins	2	15
<b>JOHN DEERE 644E, 644G</b>					
5	AT102753	Link	Bellcrank to Bucket, w/ bushings (644E)	1	201
6	T101718	Bushing		2	4
5	AT149437	Link	Bellcrank to Bucket, w/ bushings (644G)	1	201
6	T101718	Bushing		2	4
8	AT102751	Pin	Cylinder to Bellcrank	1	31
10	AT102752	Pin	Link to Bellcrank	1	26
11	AT102752	Pin	Link to Bucket	1	26
12	AT115977	Pin	Bottom Bucket Pins	2	18
<b>JOHN DEERE 644H</b>					
5	AT209081	Link	Bellcrank to Bucket, with bushings	1	176
6	R85556	Bushing		2	4
8	AT219746	Pin	Cylinder to Bellcrank	1	31
10	AT219746	Pin	Link to Bellcrank	2	31
11	AT219746	Pin	Link to Bucket	1	31
12	AT208975	Pin	Bottom Bucket Pins	2	18
<b>JOHN DEERE 644J</b>					
5	AT307549	Link	Bellcrank to Bucket, with bushings	1	176
6	R85556	Bushing		2	4
8	AT219746	Pin	Cylinder to Bellcrank	1	31
10	AT219746	Pin	Link to Bellcrank	2	31
11	AT219746	Pin	Link to Bucket	1	31
12	AT208975	Pin	Bottom Bucket Pins	2	18
<b>JOHN DEERE 744H, 744J</b>					
	AT202994	Bucket Link		1	238
	T156346	Bushing		2	5.6
	AT202938	Pin	Cylinder to Bellcrank	1	
	AT202724	Pin	Link to Bellcrank	1	
	AT202724	Pin	Link to Bucket	1	
	AT206731	Pin	Bottom Bucket Pins	2	

**BUCKET LINKS & PINS****CAT**

<b>Ref. Part No.</b>	<b>Description</b>	<b>Notes</b>	<b>Qty.</b>	<b>Wt.</b>
<b>CAT 924E, 924F</b>				
4V8641	Bucket Link		1	88
4V8663	Pin	Link to Bucket	1	9.2
4V8661	Pin	Link to Bellcrank	1	9.6
4V8661	Pin	Bellcrank to Cylinder	1	9.6
4V9901	Pin	Loader Frame to Bucket	2	8.2
<b>CAT 926E, 928F</b>				
4V4468	Bucket Link		1	101
4V3603	Pin	Link to Bucket	1	12
4V3603	Pin	Link to Bellcrank	1	12
4V3603	Pin	Bellcrank to Cylinder	1	12
4V2588	Pin	Loader Frame to Bucket	2	8.6
<b>CAT 928G</b>				
113-3797	Bucket Link		1	109
128-0285	Pin	Link to Bucket	1	14
128-0285	Pin	Link to Bellcrank	1	14
128-0285	Pin	Bellcrank to Cylinder	1	14
118-0869	Pin	Loader Frame to Bucket	2	13
<b>CAT 936E, 936F, 938F</b>				
4V2881	Bucket Link		1	107
4V3619	Pin	Link to Bucket	1	14
4V3619	Pin	Link to Bellcrank	1	14
4V3619	Pin	Bellcrank to Cylinder	1	14
4V2588	Pin	Loader Frame to Bucket	2	8.6
<b>CAT 938G, 938H</b>				
193-0953	Bucket Link		1	107
4V3619	Pin	Link to Bucket	1	14
4V3619	Pin	Link to Bellcrank	1	14
4V3619	Pin	Bellcrank to Cylinder	1	14
4V2588	Pin	Loader Frame to Bucket	2	8.6
<b>CAT 950E, 950F</b>				
5V1530	Bucket Link		1	128
5V1882	Pin	Link to Bucket	1	21
5V1508	Pin	Link to Bellcrank	1	23
5V1508	Pin	Bellcrank to Cylinder	1	23
5V1511	Pin	Loader Frame to Bucket	2	15
<b>CAT 950G, 950H</b>				
127-6371	Bucket Link		1	128
5V1882	Pin	Link to Bucket	1	21
5V1508	Pin	Link to Bellcrank	1	23
5V1508	Pin	Bellcrank to Cylinder	1	23
5V1511	Pin	Loader Frame to Bucket	2	15
<b>CAT 924G, 924GZ, 924H, 924HZ</b>				
148-7798	Bucket Link		1	91
148-7872	Pin	Link to Bucket	1	9.2
148-7873	Pin	Link to Bellcrank	1	12
148-7873	Pin	Bellcrank to Cylinder	1	12
148-7871	Pin	Loader Frame to Bucket	2	8.2